

SEA[®]

Sistemi Elettronici
di Apertura Porte e Cancelli
International registered trademark n. 804888



English

HYDRAULIC OPERATOR FOR SWING GATE

FULL TANK



INSTALLATION MANUAL and Security Information

FEATURES AND SPECIFICATIONS

The **FULL TANK** is a high quality hydraulic operator for condominium use for gates with leaf lengths up to max. 7 m.

Available in the following versions:

AC (with lock in opening and closing position)

SC (with lock only in closing position)

SA (with lock only in opening position)

SB (without lock)

The lock is guaranteed for leaf lengths up to 180 m with the 270 version and up to 2,20 m with the 390 version. For leaf lengths exceeding 2,20 m it is necessary, in all versions, to install an electric lock.

The Full Tank is supplied with by-pass valves for the power regulation in both opening and closing. Electronic adjustable slow down in opening and closing with electronic control board. For the European laws and directives actually in force it is strongly recommended to use the Safety Gate (device for the reading of the gate position), for reverse in case of obstacle.

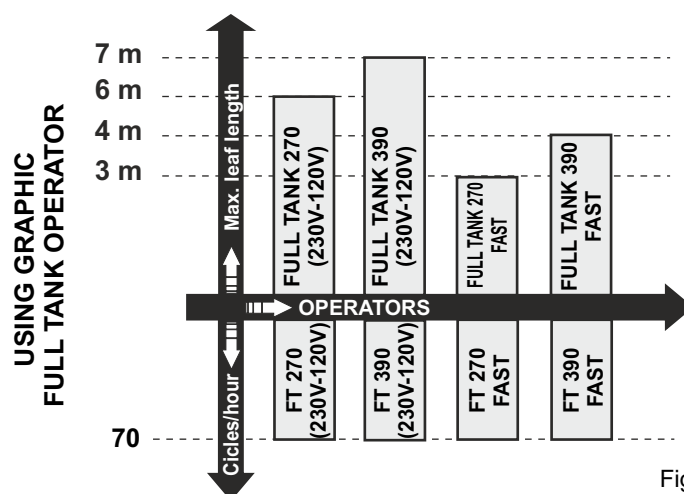
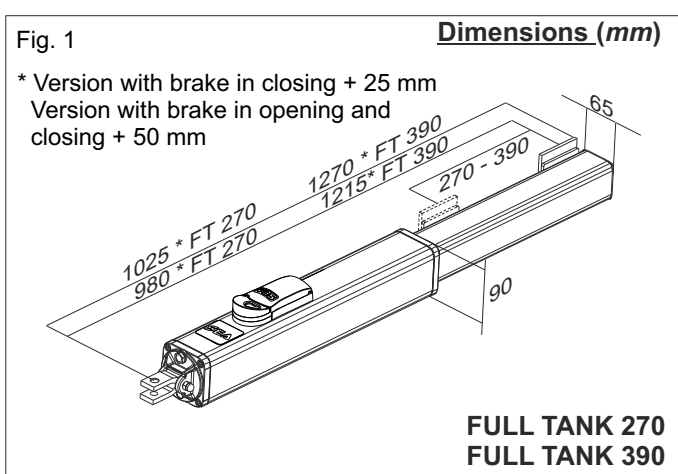
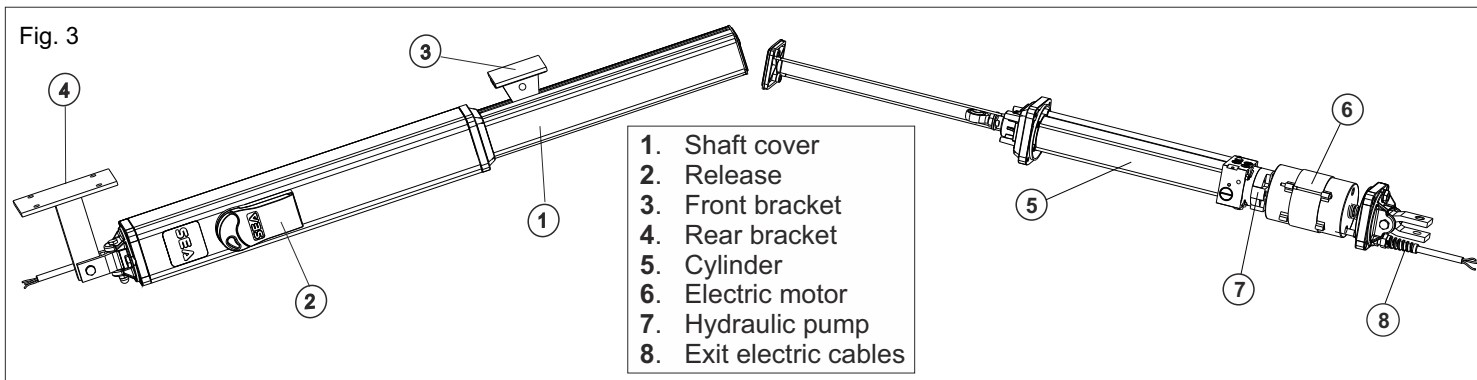

Fig. 2



TECHNICAL FEATURES	FT 270 (230V)	FT 390 (230V)	FT 270 (120V)	FT 390 (120V)	FT 270 FAST	FT 390 FAST
Power supply	230V (±5%) 50/60 Hz		120V 60 Hz		230V (±5%) 50/60 Hz	
Power	220 W		300 W		310 W	
Absorbed current	1 A		2,45 A		1,5 A	
Stroke	270 mm	390 mm	270 mm	390 mm	270 mm	390 mm
Shaft speed	1 cm/s	1,5 cm/s	1,2 cm/s	1,7 cm/s	3,35 cm/s	
Cycles hour (at a temp. of 20°C)	70					
Max working pressure	40 bar	30 bar	40 bar		35 bar	
Operating temperatures	-20°C ↕ +55°C ↕					
Thermal protection	130°C					
Max Thrust	640da N			480 daN	500 daN	
Capacitor	12,5µF		60µF		12,5µF	
Weight	12,8 kg	15,2 kg	12,8 kg	15,2 kg	13 kg	15,4 kg
Protection class	IP55					
Max leaf lenght	6 m	7 m	6 m	7 m	3 m	4 m
Opening degree of the leaf	90° / 125°					

Note: The frequency of use is valid only for the first hour at 20°C room temperature.

Note: in non-automatic logic, use operators without lock.

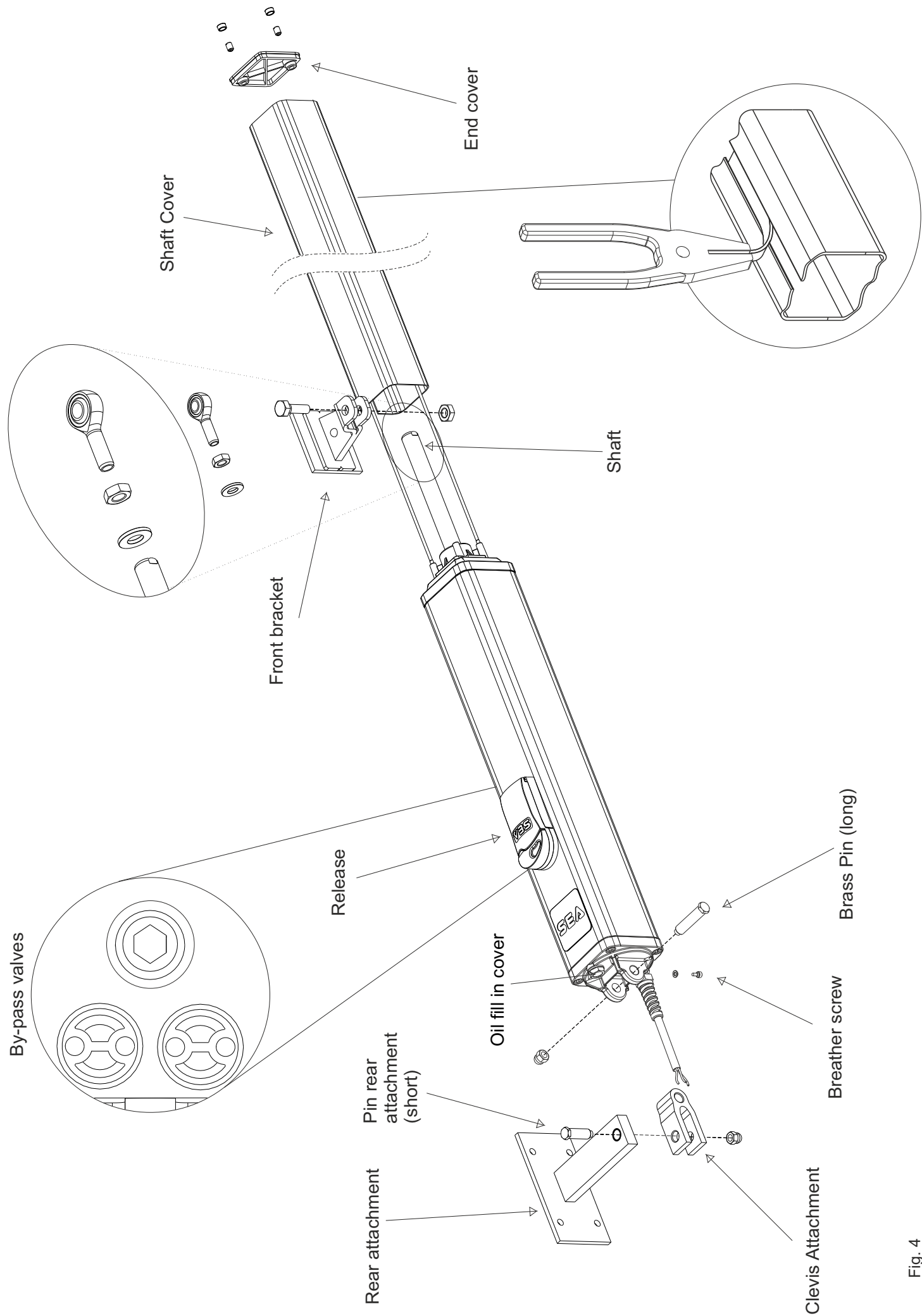
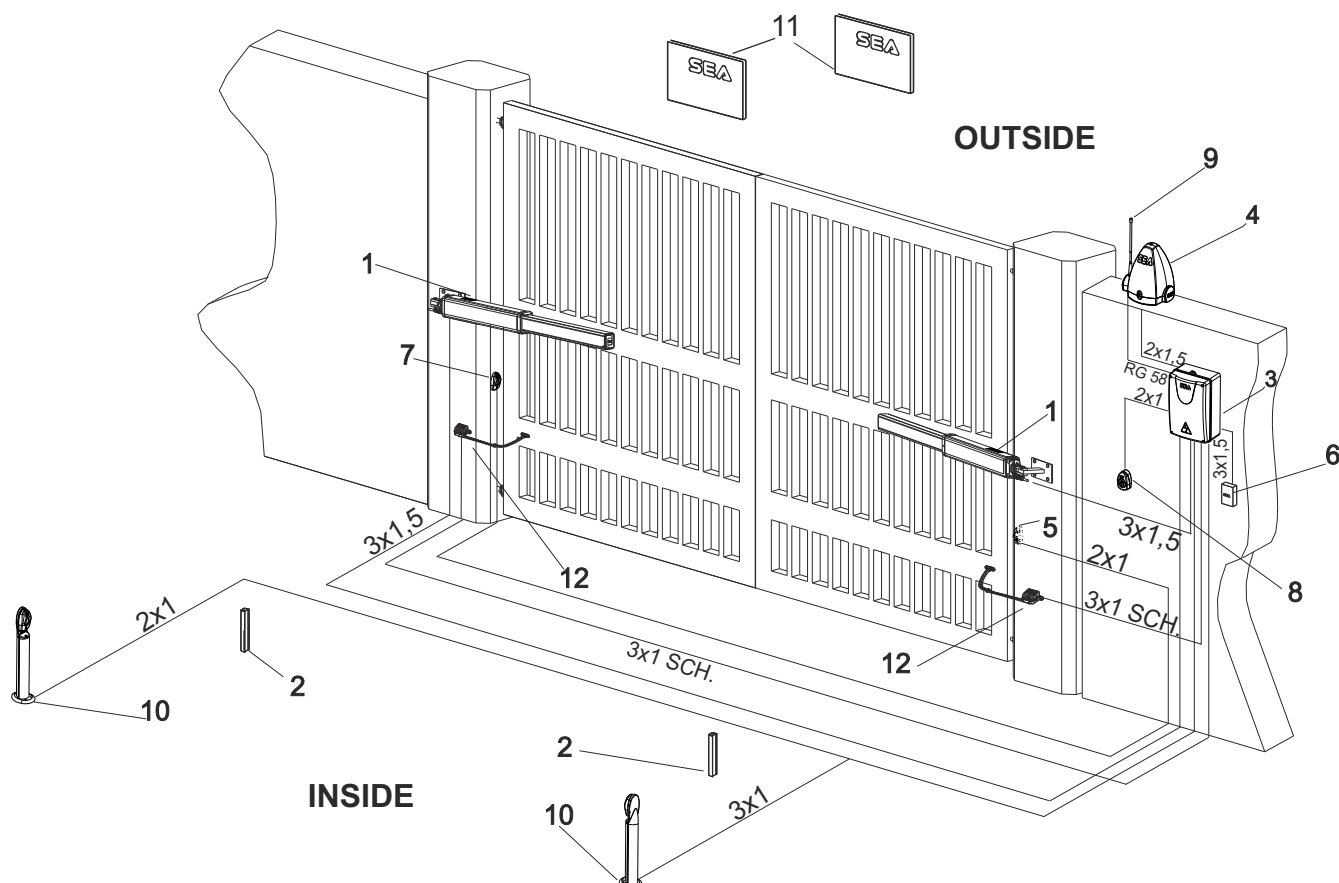

Fig. 4

TYPICAL INSTALLATION



1. Full Tank operator
2. Mechanical stop
3. Control board
4. Warning lamp
5. Photocell tx
6. Differential switch 16A-0,03A

7. Photocell rx
8. Key switch start-stop
9. Antenna
10. Column for photocells
11. Warning notice
12. Safety Gate

TYPE OF INSTALLATION

It is possible to install the Full Tank with opening inside (Fig.5) or opening outside (Fig.6).

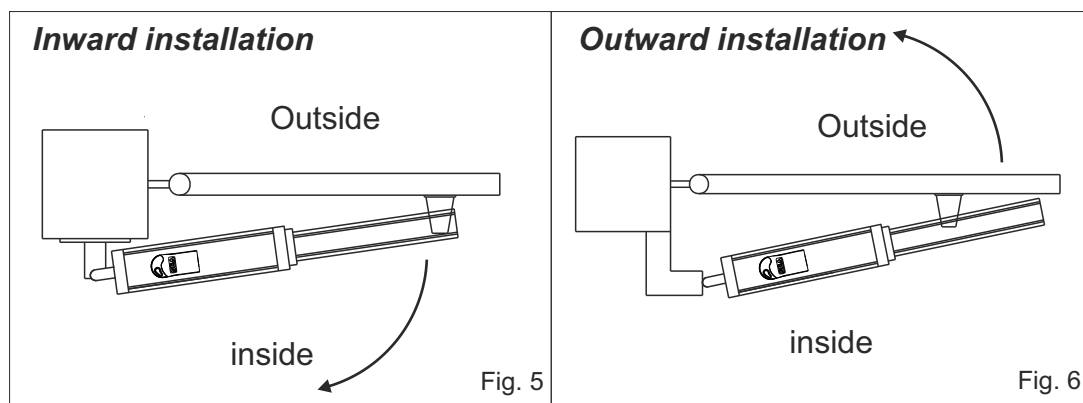

Install the operator always inside the property.

INSIDE OPENING INSTALLATION

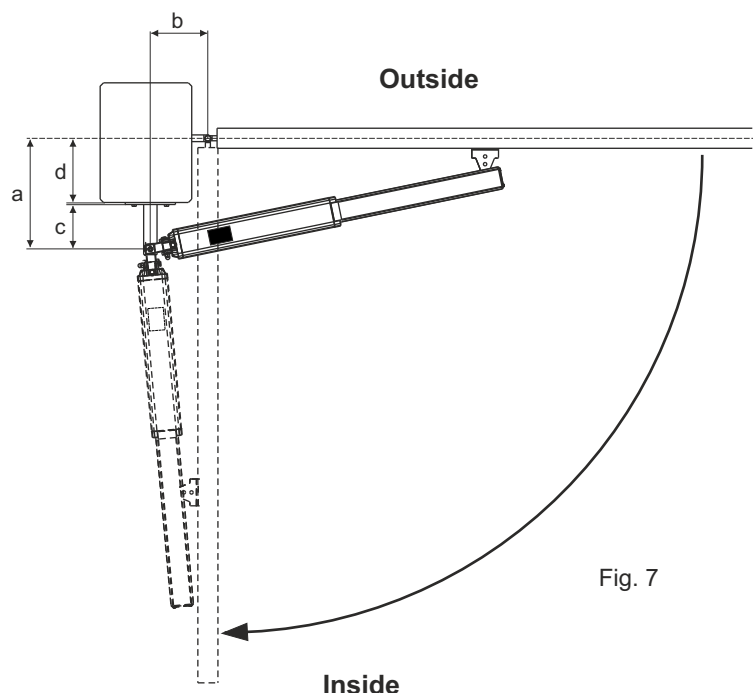

Total stroke 270 mm - max. recommended stroke 250 mm

a (mm)	b (mm)	d _{max} (mm)	Max. Opening Angle	Max. Stroke (mm)	Stroke for 90°(mm)
100	115	50	110°	250	215
100	150	50	90°	250	
105	110	55	110°	245	215
105	145	55	90°	250	
120	105	70	106°	250	225
120	130	70	90°	250	
125	125	75	90°	250	
140	95	90	100°	250	235
140	110	90	90°	250	
145	95	95	100°	255	242
145	105	95	90°	250	
150	100	100	90°	250	
155	85	105	96°	250	242
160	90	110	90°	253	
170	75	120	92°	250	
180	65	130	92°	250	

To obtain 110° with d > 55 mm it is necessary to make a niche in the gate.

INSIDE OPENING INSTALLATION

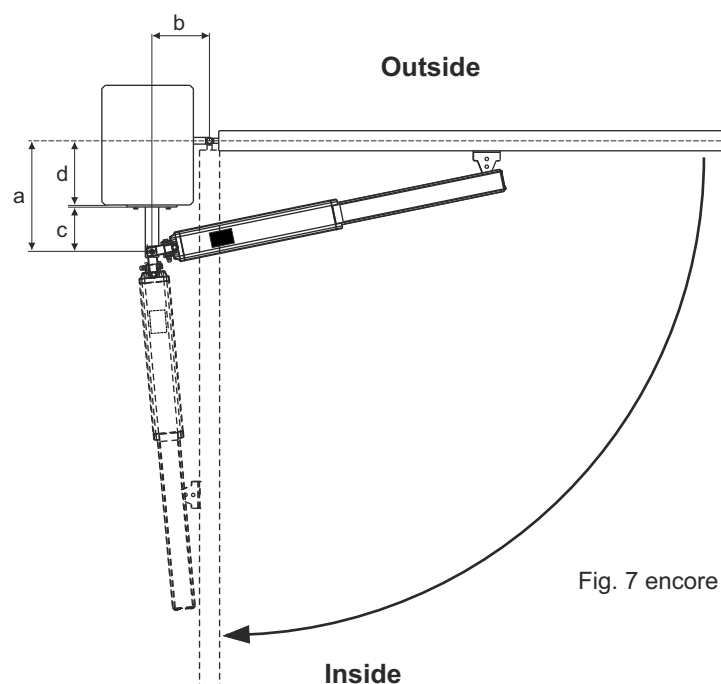

Total stroke 390 mm - max. recommended stroke 370 mm

a (mm)	b (mm)	d _{max} (mm)	Max. Opening Angle	Stroke max (mm)	Stroke for 90°(mm)
125	170	75	125°	368	295
130	170	80	125°	372	300
140	235	90	90°	370	
145	165	95	120°	372	310
145	230	95	90°	370	
160	210	110	90°	370	
175	195	120	90°	370	
185	145	130	110°	370	330
185	190	130	90°	370	
195	140	140	110°	371	355
195	175	140	90°	370	
240	110	185	100°	370	355
240	125	185	90°	370	
250	105	195	95°	370	360
250	115	195	90°	370	
260	95	205	95°	369	365
260	100	205	90°	370	
270	90	215	90°	370	
280	80	230	90°	370	
295	65	245	90°	369	

To obtain 125° with d > 55 mm it is necessary to make a niche in the gate.

OUTSIDE OPENING INSTALLATION

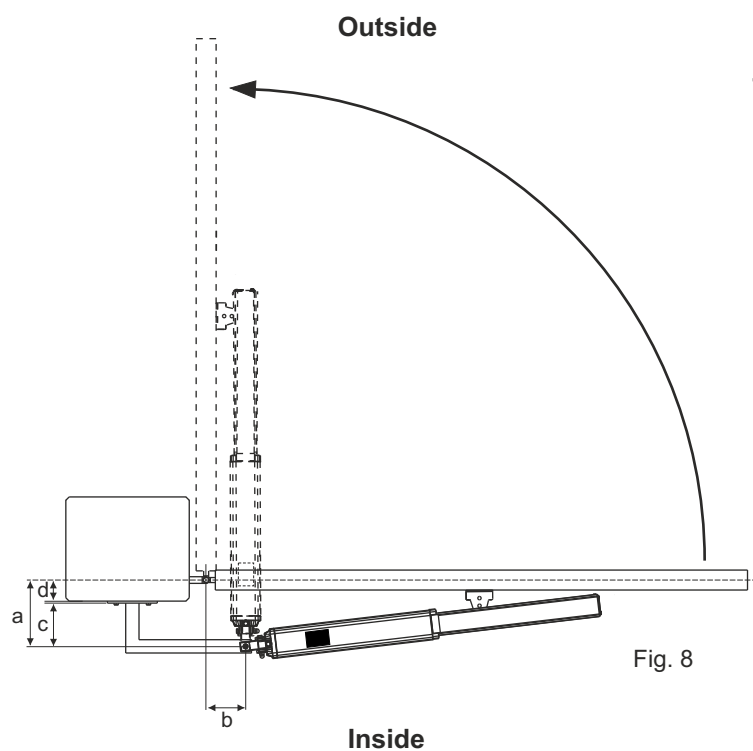

Total stroke 270 mm - max. recommended stroke 250 mm

a (mm)	b (mm)	Max. Opening Angle	Stroke max (mm)	Stroke for 90°(mm)
150	90	95°	250	240
160	90	90°	250	
165	80	95°	249	243
175	80	90°	250	
180	70	90°	250	
180	65	90°	241	

OUTSIDE OPENING INSTALLATION

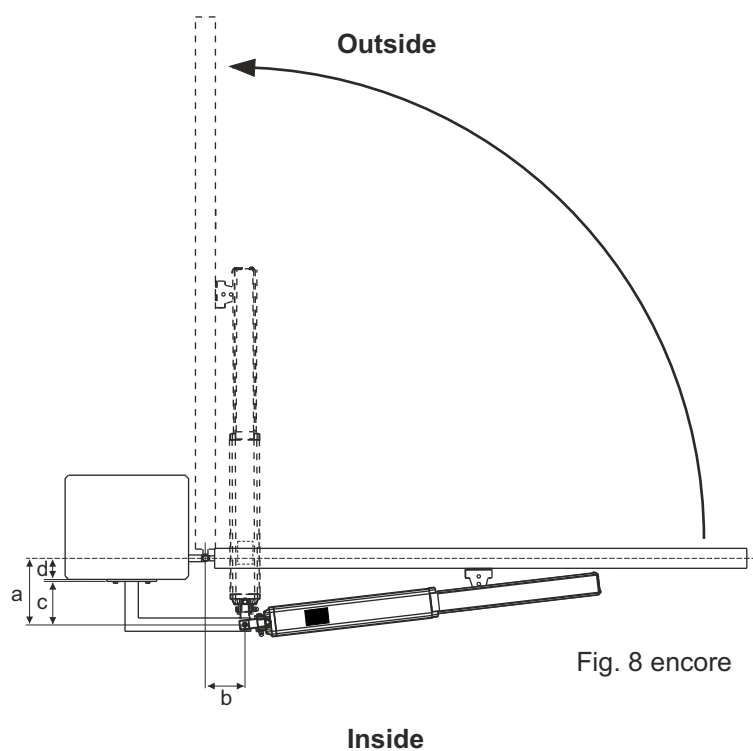

Stroke 390 mm - max. recommended stroke 370 mm

a (mm)	b (mm)	Max. Opening angle	Max. Stroke (mm)	Stroke for 90°(mm)
250	100	100°	356	342
255	95	95°	345	336
265	95	95°	342	335
270	90	90°	330	
275	90	90°	325	
275	90	90°	319	

INSTALLATION ON MASONRY PILLARS, MAKING A NICHE

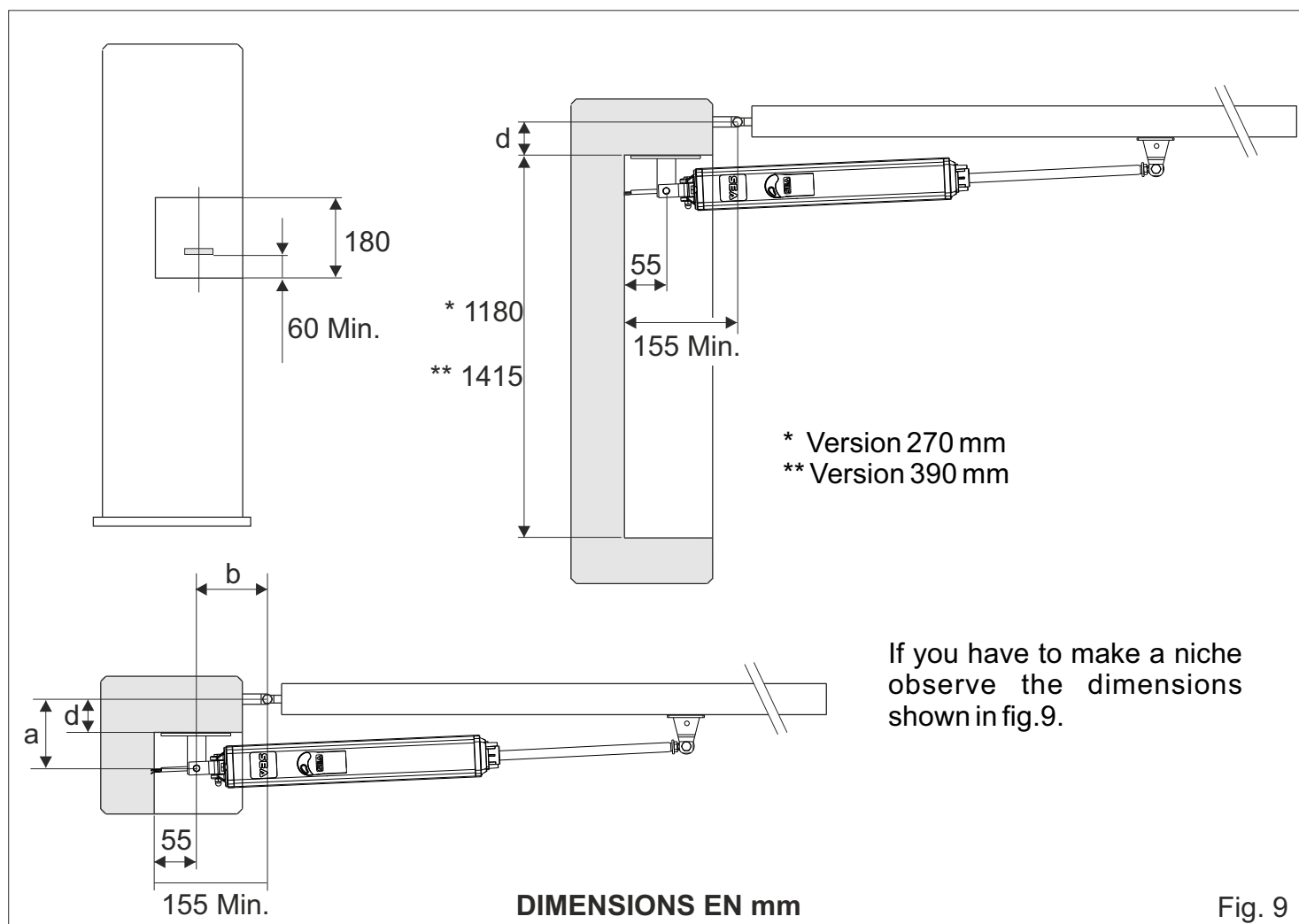

RELEASE MOUNTING

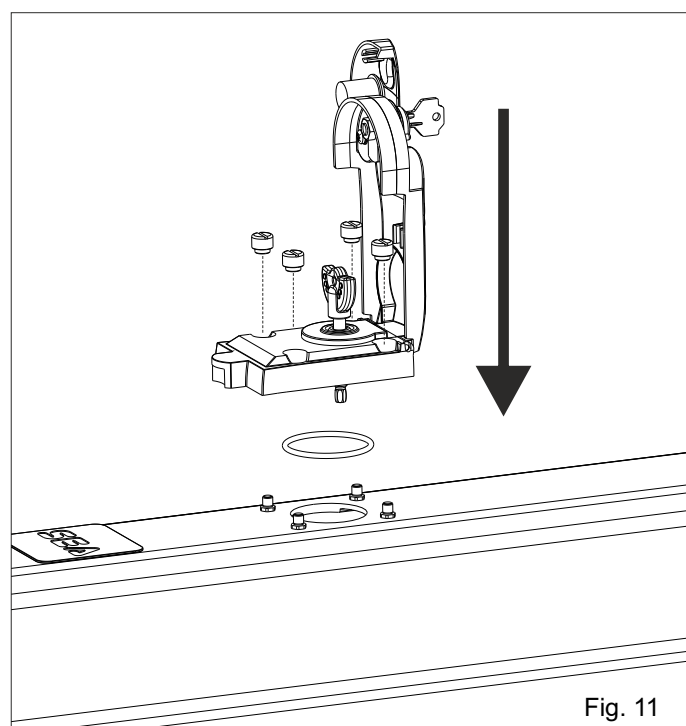
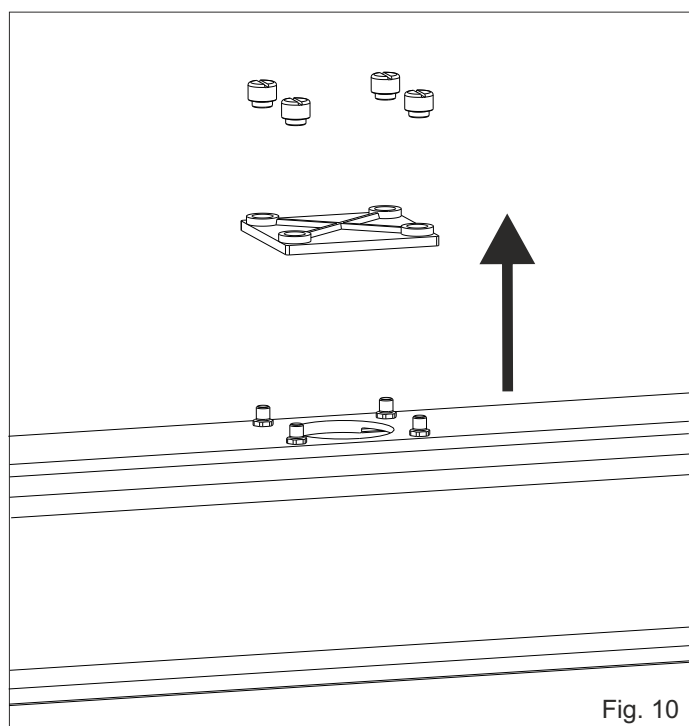

Remove the transporting plate as shown in Fig. 10.

Mount the release as shown in Fig. 11.

INSTALLATION OF THE OSCILLATING REAR BRACKET

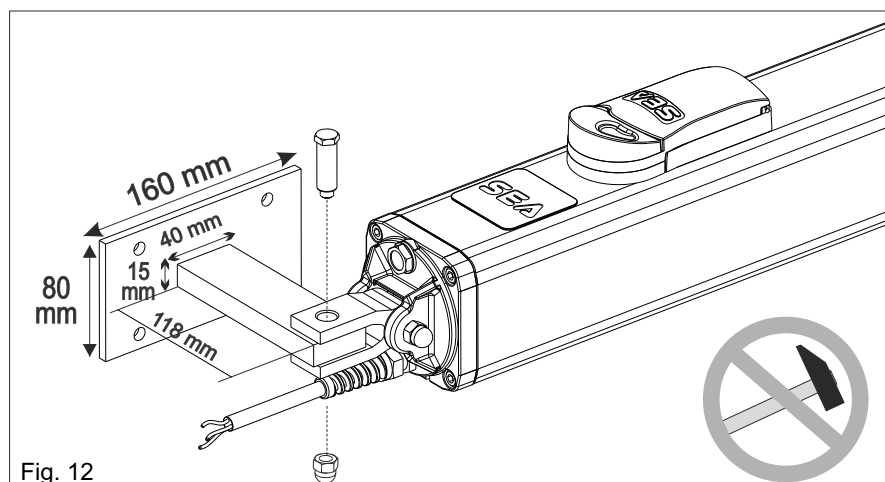

Fig. 12

PRELIMINARY:

- Open carefully the package, making sure not to lose parts which are listed in fig. 4.
- Attach the rear oscillating bracket as shown in fig. 12

Attention: Do not use a hammer for the insertion of the short brass pin; its fitting into the bracket and clevis attachment must be done by the simple pressure of the hands.

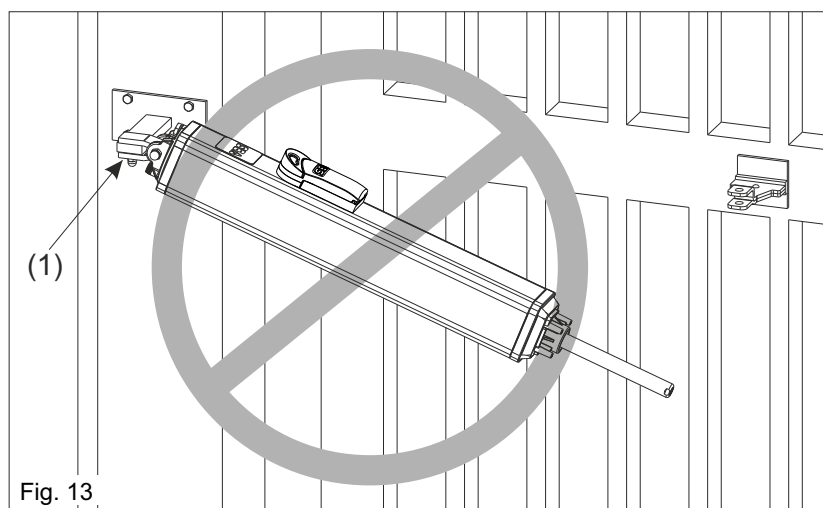

Fig. 13

Attention: Do not incline the hydraulic operator further than the allowed angle of the oscillating bracket (1), risks the possible braking of it.

INSTALLATION OF REAR BRACKET

According to the type of opening that you have chosen (inside or outside) and to the chosen leaf rotation (see pag. 19-20), the rear bracket must first be cut respecting the quote "a" on pag. 19-20 and then welded as in fig. 15.

The support must be positioned so that the operator is perfectly levelled (Fig. 15, Fig. 16)

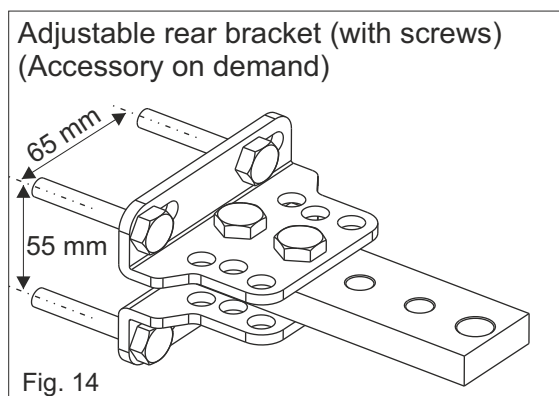

Fig. 14

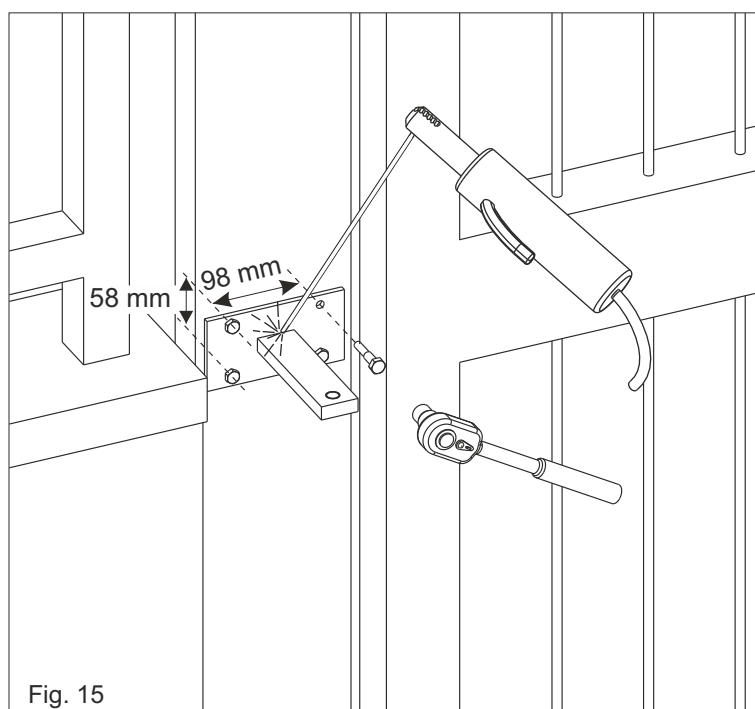

Fig. 15

POSITIONING OF THE FRONT BRACKET

Once the operator is attached to the post and the leaf set in the closed position execute the following operations:

1. Release the operator.
2. Pull-out completely the chromate shaft and push it back in 1 cm.
3. Attach the shaft to the front bracket (Fig. 17).
4. Set the operator perfectly levelled and mark the position of the front bracket (Fig. 16).

Attention: avoid the welding of the front bracket to the shaft of the hydraulic operator already attached; the welding scraps (daps) could ruin the chromium plating of the shaft.

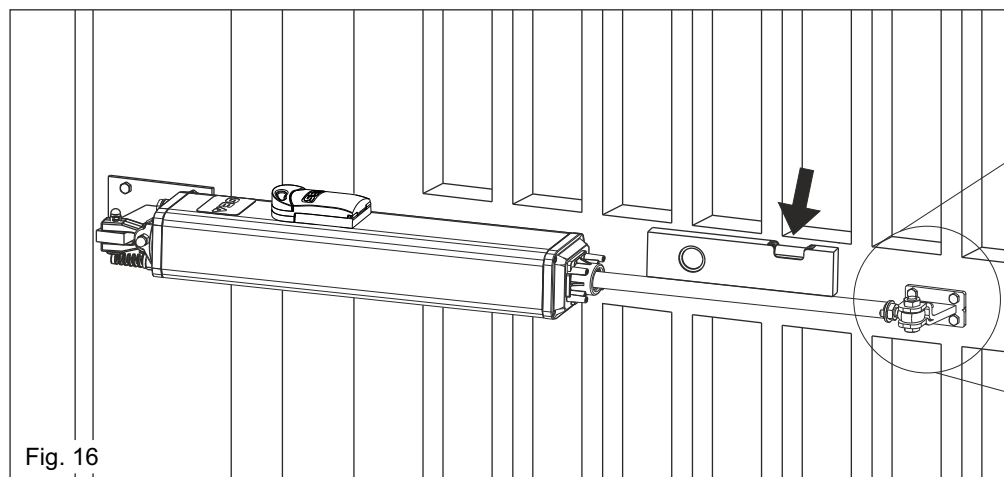

Fig. 16

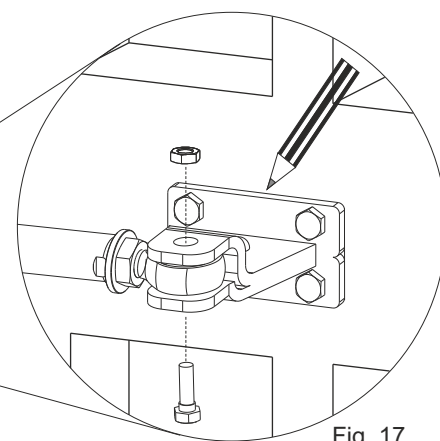

Fig. 17

WELDING OF THE FRONT BRACKET TO THE GATE

The front bracket must be positioned so that the operator is perfectly levelled

According to the nature of the gate the front bracket (wood, steal, Aluminium) can be:

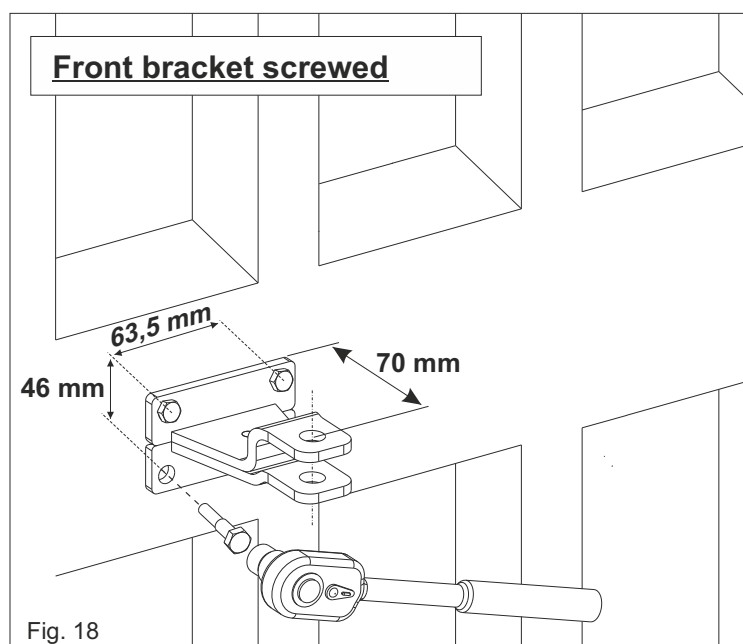

Fig. 18

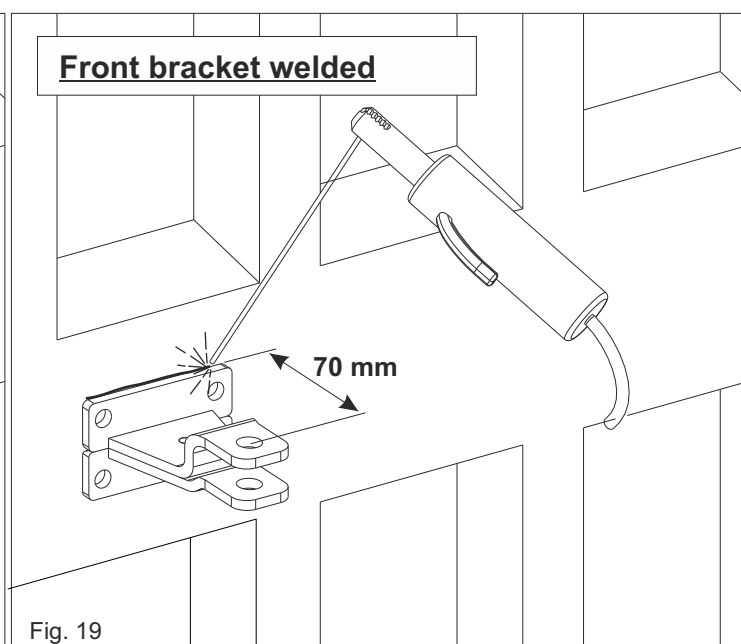

Fig. 19

INSTALLATION OF POSITIVE STOPS (Accessories on request)

- Release the unit (as in Fig. 30).
- Let the rod come out about 3/4 of its run.
- Put the limit switch stops on the front flange of the unit with the two rods (of the three which are present on the stop) which are in parallel to the gate (Fig. 20).
- Fix the stop with the two included screws.
- Put the provided bush into the rod.
- At this point hook the rod on the front fixation.
- To adjust the stop in opening act on disc, and in closing on disc 2.

Attention: the mounting of the mechanical stop does not cause the reduction of the stroke.

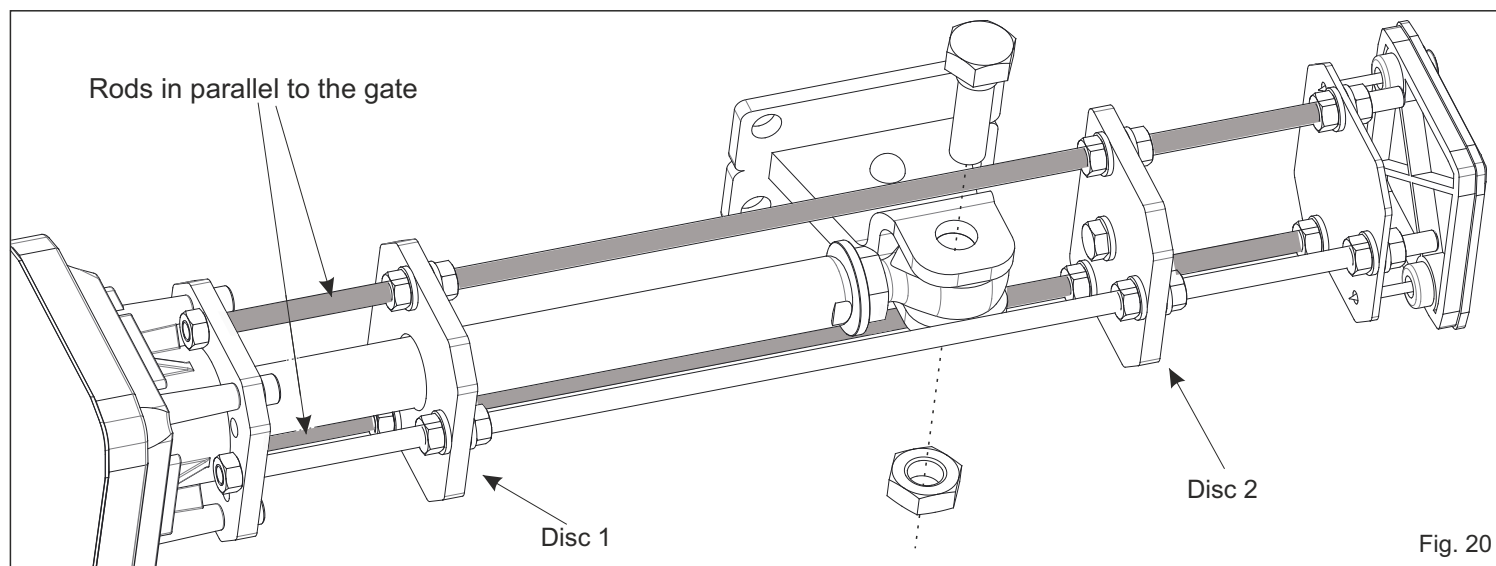
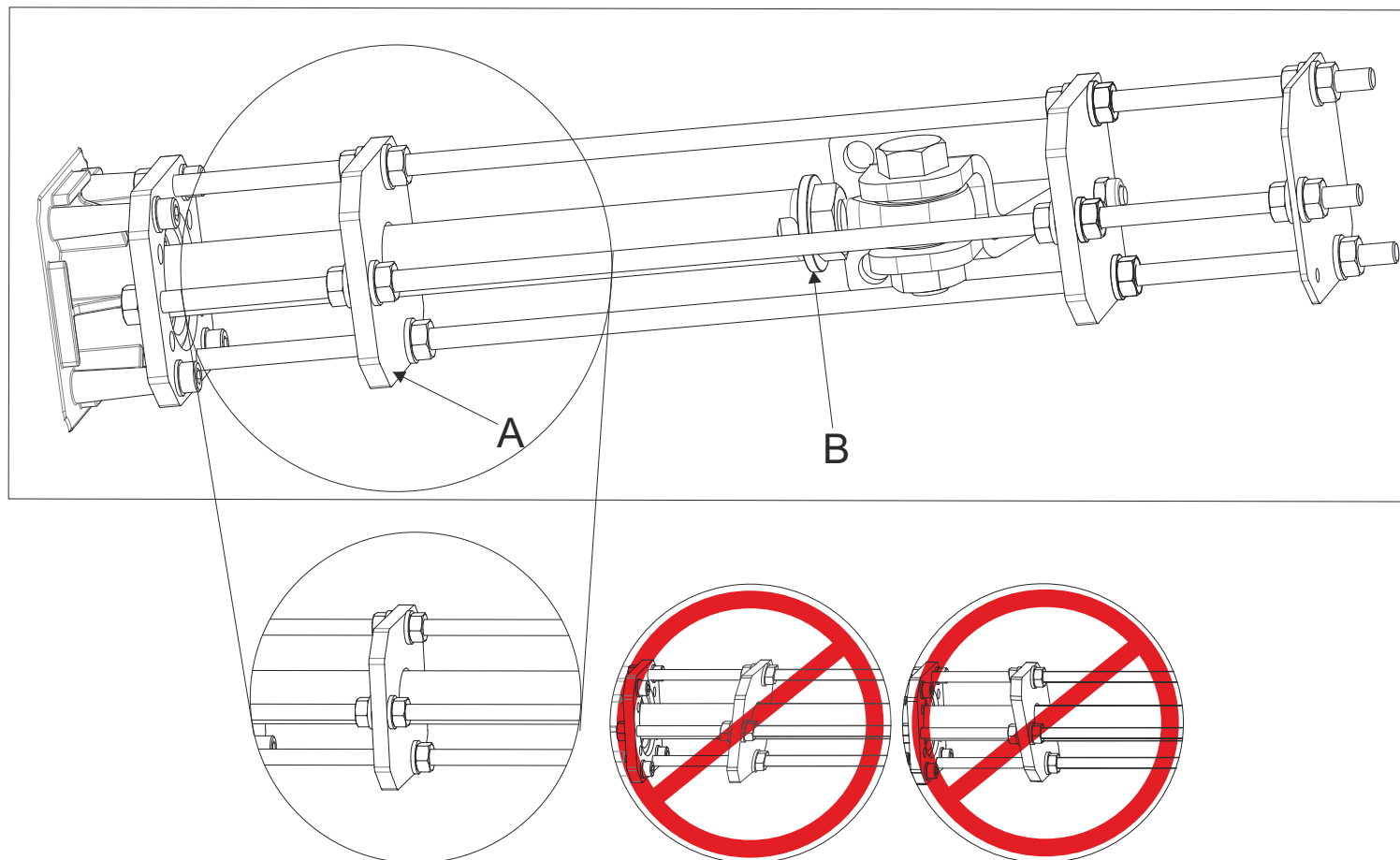
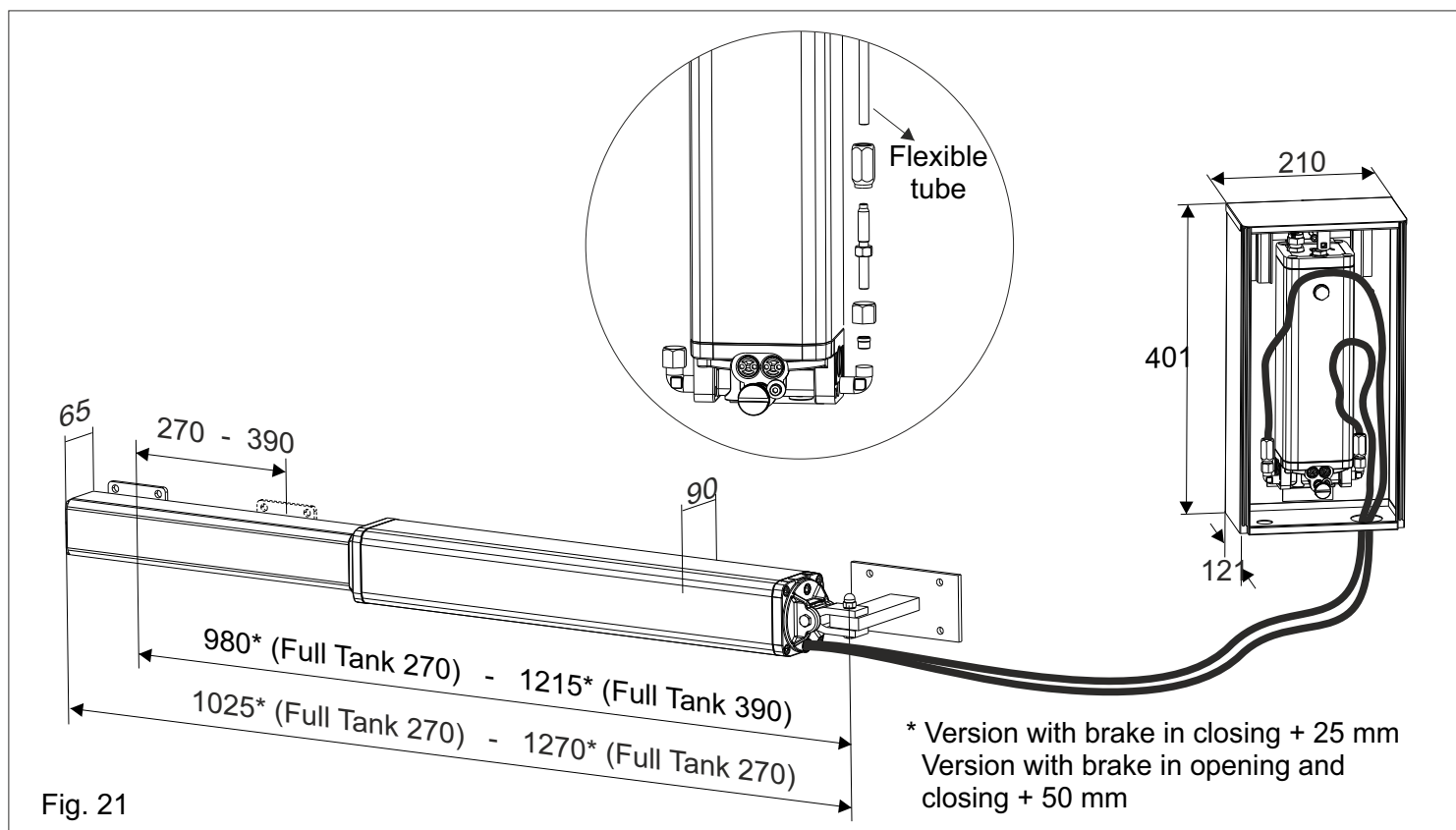

Fig. 20



ATTENTION: Make sure that the two discs A and B perfectly fit in opening phase

FULL TANK WITH SEPARATE HYDRAULIC UNIT



BREATHER SCREW

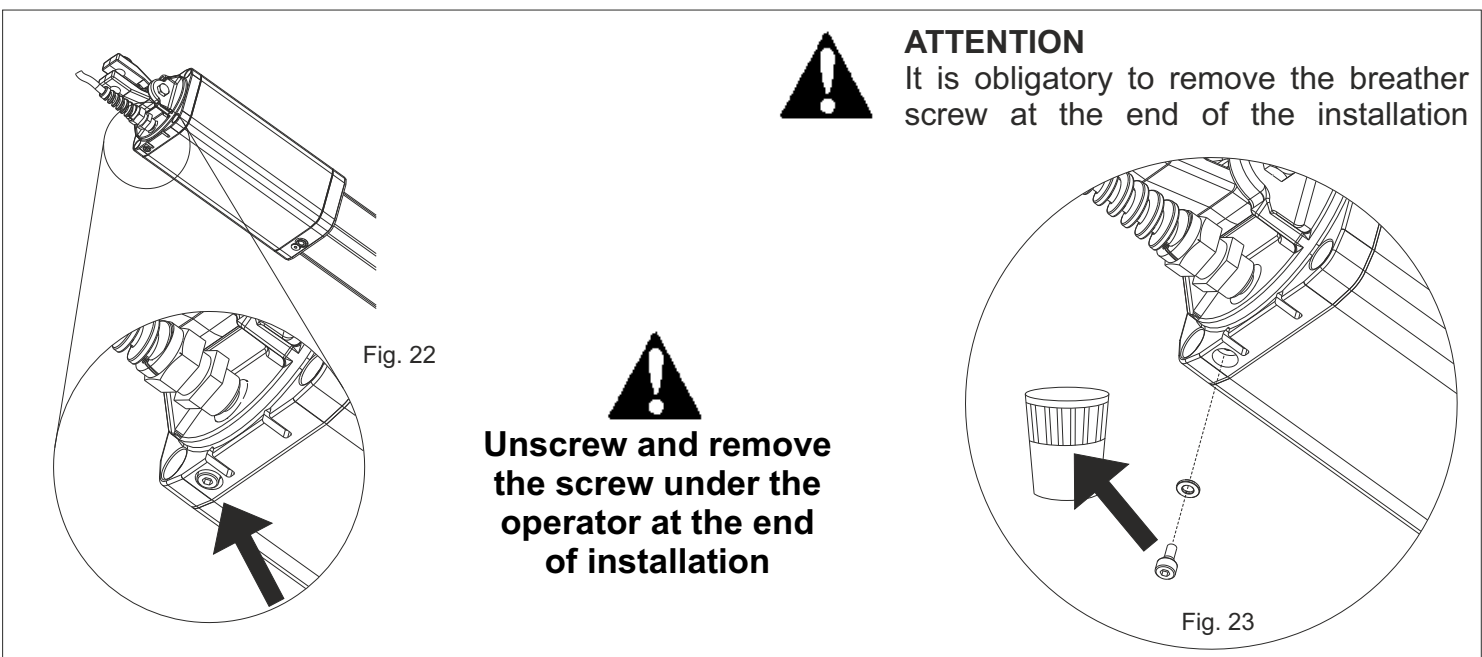

TORQUE ADJUSTMENT (by pass valves)

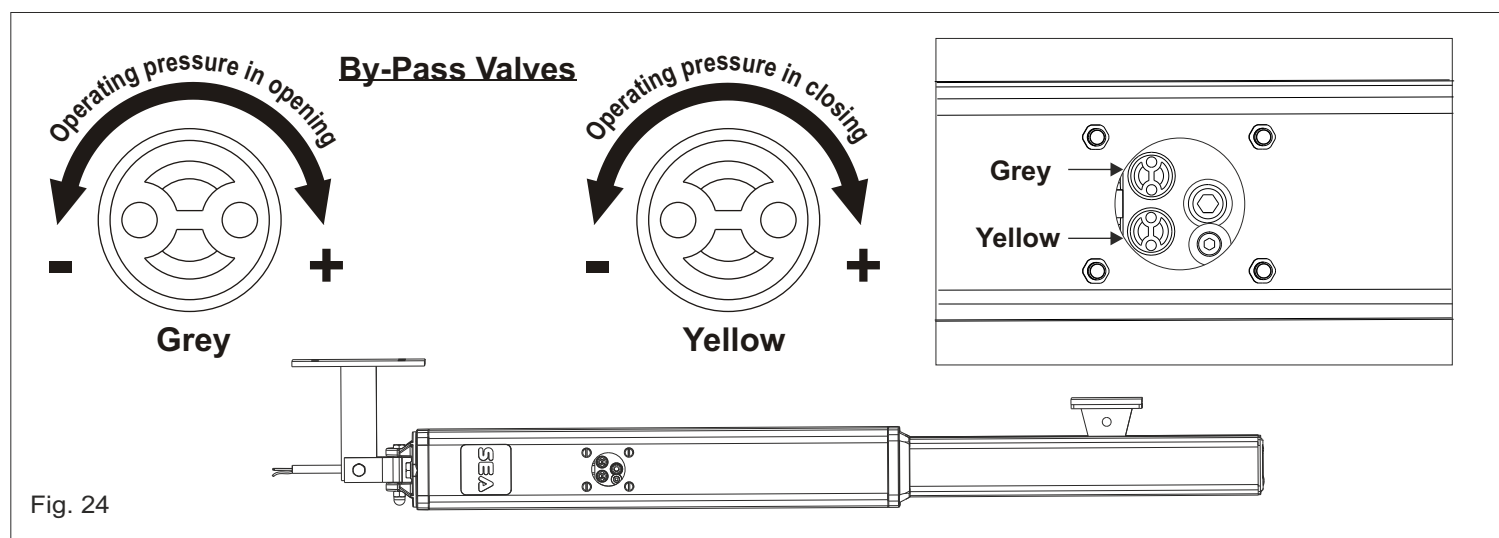

Adjust the opening and closing forces of the gate so that the diagram of the force is respected (present in the regulation EN 12453); Anyway the max. thrust force should never be superior of 15 kgF.

INSTALLATION OF THE CHROME PLATED SHAFT COVER

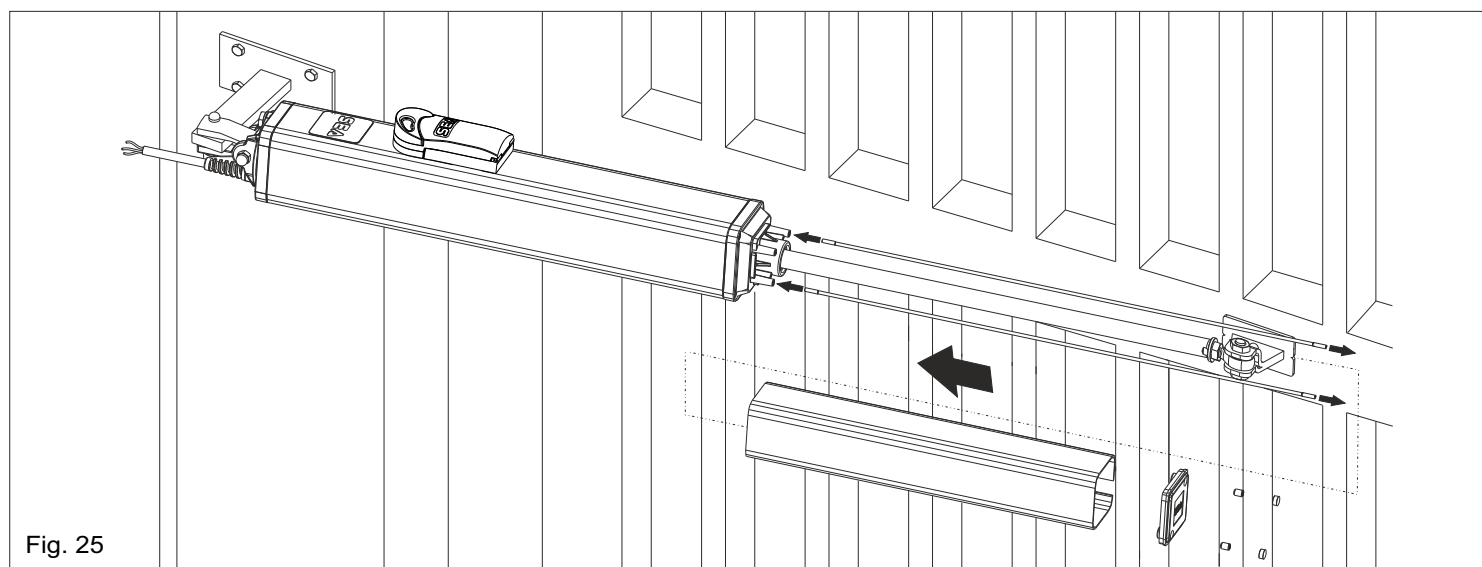

OIL LEVEL MEASUREMENT

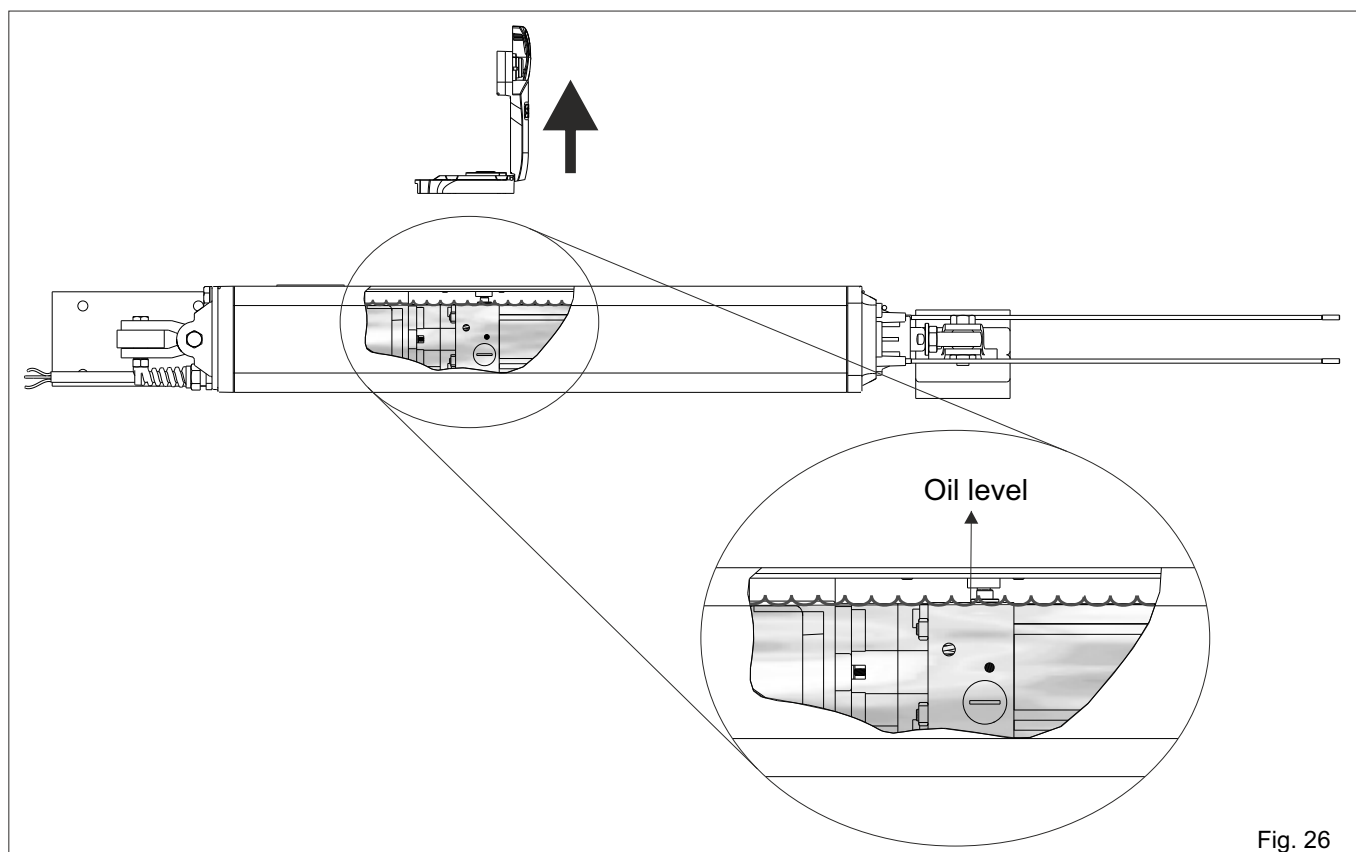
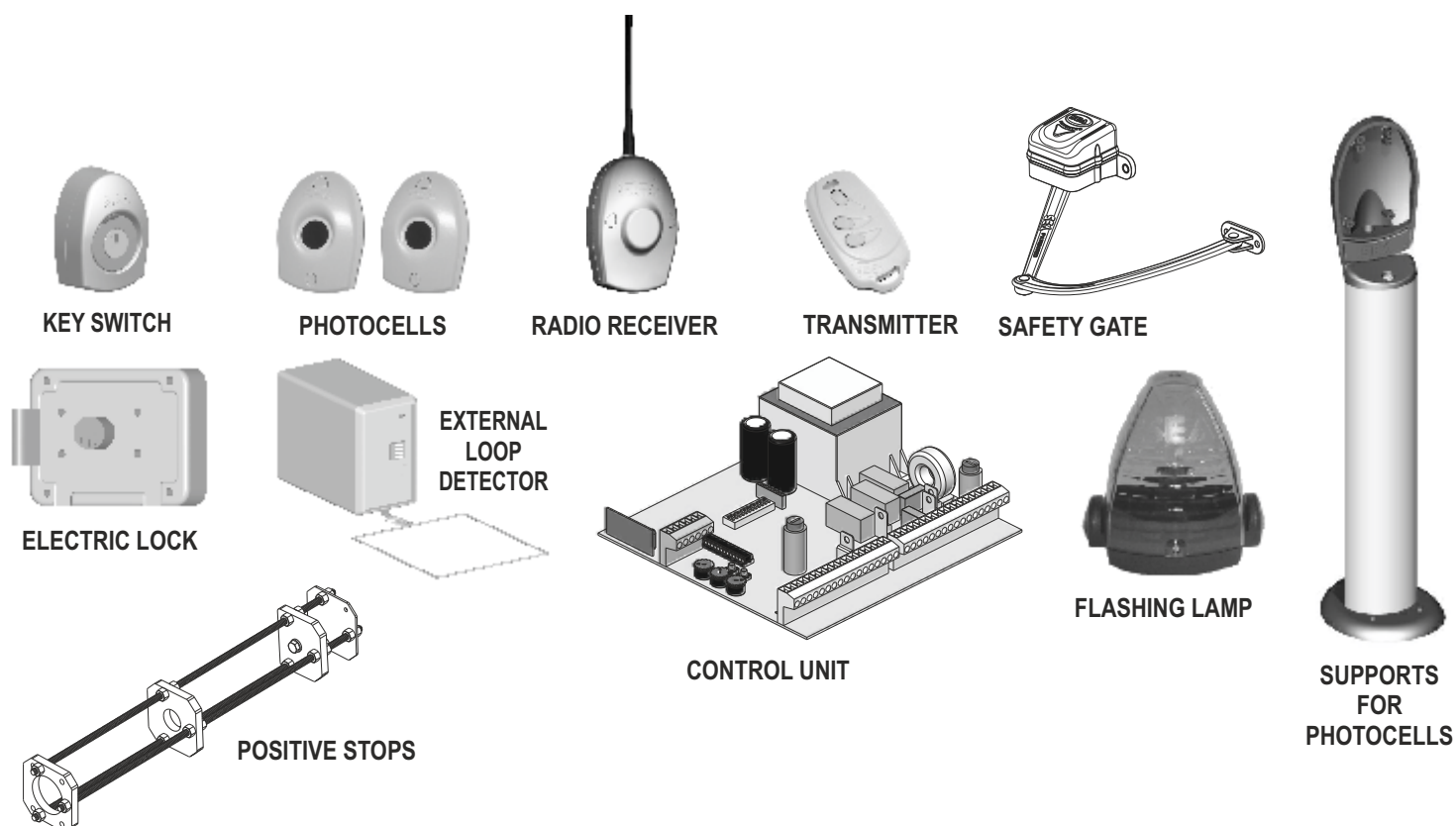

Fig. 26

The oil level should be measured with the rod inserted into the actuator and must stand in accordance with the distributor.

FULL TANK ACCESSORIES



RISK EXAMINATION

The points pointed by arrows in fig. 27 are potentially dangerous. The installer must take a thorough risk examination to prevent crushing, conveying, cutting, grappling, trapping so as to guarantee a safe installation for people, things and animals. (Re. Laws in force in the country where installation has been made.) As for misunderstandings that may arise refer to your area distributor or call our help desk. These instructions are part of the device and must be kept in a well known place.

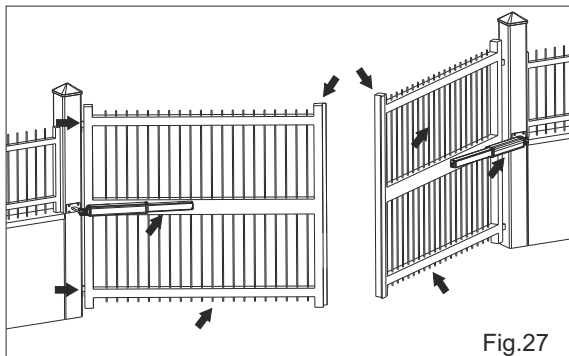

Fig.27

The installer shall follow the provided instructions thoroughly. SEA products must only be used to automatise doors, gates and wings. Any initiative taken without SEA explicit authorization will preserve the manufacturer from whatsoever responsibility. The installer shall provide warning notices on not assessable further risks. SEA in its relentless aim to improve the products, is allowed to make whatsoever adjustment without giving notice. This doesn't oblige SEA to up-grade the past production. SEA can not be deemed responsible for any damage or accident caused by product breaking, being damages or accidents due to a failure to comply with the instructions herein. The guarantee will be void and the manufacturer responsibility will be nullified if SEA original spare parts are not being used. The electrical

installation shall be carried out by a professional technician who will release documentation as requested by the laws in force. Packaging materials such as plastic bags, foam polystyrene, nails etc must be kept out of children's reach as dangers may arise.

INITIAL TEST AND STARTING OF THE AUTOMATION

After having completed the necessary operations for a correct installation of the Full Tank product, as described in this manual, and after having valuated all resting risks which could arise in any installation, **it is necessary to test the automation to guaranty the maximum security and, in particular way, to guaranty that the laws and norms of**

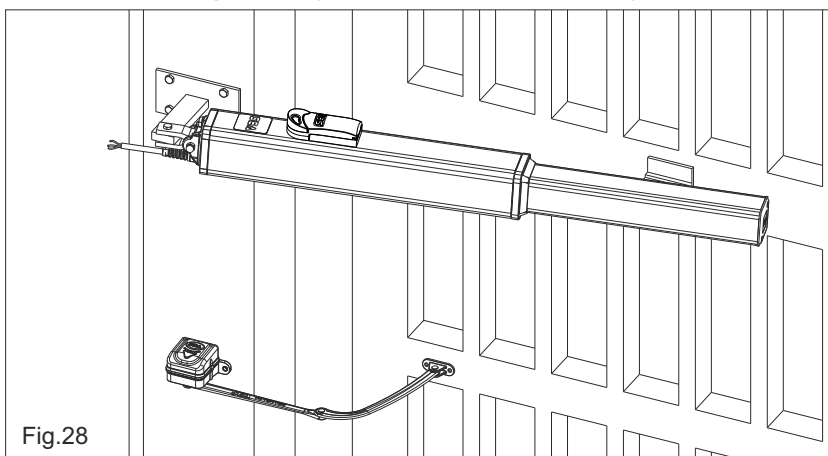

Fig.28

this sector are fully respected. Especially the test must be executed following the norm **EN 12445** which establishes the methods of tests for checking the gate automations respecting the limits established by the rule **EN 12453**.

SAFETY GATE

For a correct and safe installation it is strongly recommended to install a Safety Gate, **which allows the fulfilment of the force diagram included in the norm EN 12453** and consequently the test and start of the whole installation.

SAFETY PRECAUTIONS:

All electrical work should conform to current regulations. A 16 A 0,030 A differential switch must be incorporated into the source of the operators main electrical supply and the entire system properly earth bonded. Always run mains carrying cables in separate ducts to low voltage control cables to prevent mains interference.

INTENDED USE:

The operator Full Tank has been planned to be used for the automation of swing gate operator only.

SPARE PARTS:

To obtain spare parts contact: **SEA S.p.A. -Zona Ind.le, 64020 S. ATTO Teramo Italia**

SAFETY AND ENVIRONMENTAL COMPATIBILITY:

Don't waste product packing materials and/or circuits.

When being transported this product must be properly packaged and handled with care.

LIMIT OF GUARANTEE

For the guarantee see the sales conditions on the official SEA price list.

MAINTENANCE AND OUT OF SERVICE:

The decommission and maintenance of this unit must only be carried out by specialised and authorised personnel.

NOTE: THE MANUFACTURER CAN NOT BE DEEMED RESPONSIBLE FOR ANY DAMAGE OR INJURY CAUSED BY IMPROPER USE OF THIS PRODUCT.

SEA reserves the right to do changes or variations that may be necessary to its products with no obligation to notice.

To the attention of users and technicians

RELEASE SYSTEM

To release operate as follows:

open the lock cover, insert the key, turn it about 90° clockwise (see fig.29) and open the lid.
Take the red key located under the lid, insert it and turn it about 90° anti-clockwise (see fig.30).

To relock the operator do as follows:

turn the red key clockwise until it stops (see fig.30), remove it, put it under the lid and close the lid again.

Attention: Turning the key over 1 turn (360°) could damage the release.

Turn the key anti-clockwise to tighten the lid, remove the key and close the lock cover.

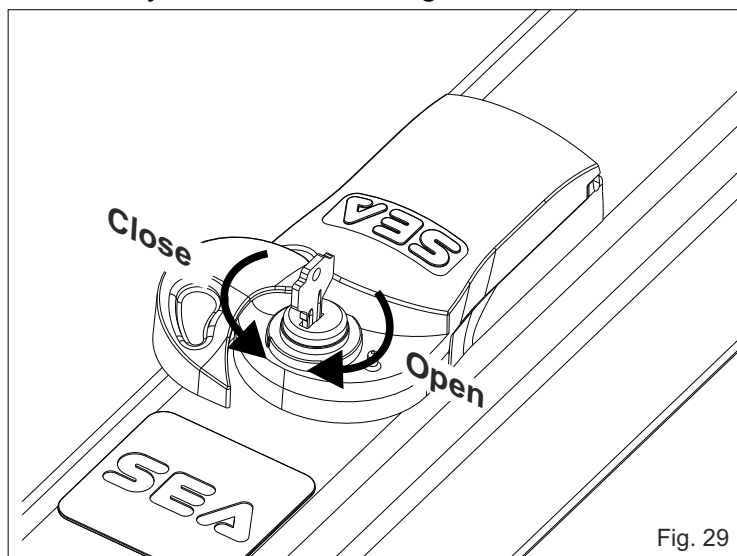

Fig. 29

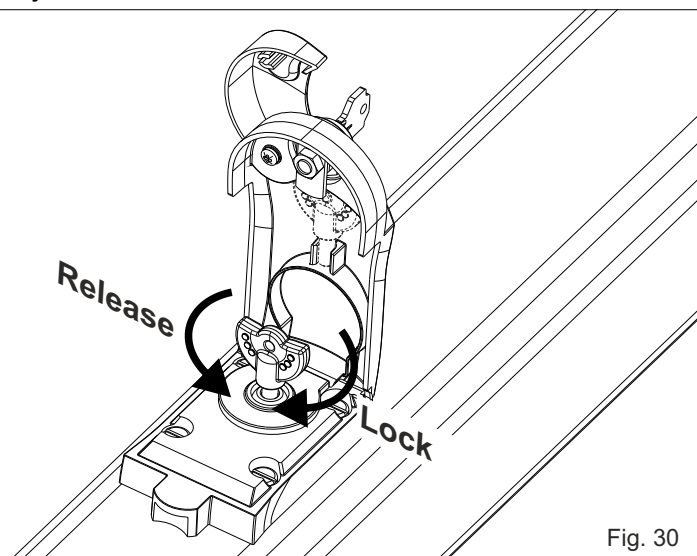

Fig. 30

WARNING: SEA recommends to the end user to release the operator only after having switched off the electric power. Always contact a professional installer in case of not correct working of the operator.

PERIODICAL MAINTENANCE

1) Check the solidity and the stability of the gate, especially the points of support and/or rotation of the gate (pivots)	Annual
2) Check the oil level of the hydraulic/in oil bath operators (cap on rear cover of the Full Tank)	Annual
3) Change the hydraulic oil with the one recommended from the head company	4 years
4) Check the release function	Annual
5) Check the by-pass valves function	Annual
6) Check and lubricate the fixing pins	Annual
7) Check the integrity of the connection cables	Annual
8) Check the function and the positive stops condition in opening and closing (where there is present a mechanical positive stop accessory)	Annual
9) Check the good status of all parts which are forced (rear bracket, oscillating bracket and front bracket)	Annual
10) Check the operating of all accessories, especially the function of all safety devices and of the Safety Gate	Annual
11) Lubricate the shaft (see Fig.4) with SEAgrease (GREASE GL 00 Cod.65000009)	Annual
12) After having executed the periodical maintenance operations it is necessary to repeat the test and the putting in service of the automation	Annual

All the above described operations MUST be made exclusively by an authorized installer



English GENERAL NOTICE FOR THE INSTALLER AND THE USER

1. Read carefully these **Instructions** before beginning to install the product. Store these instructions for future reference
2. Don't waste product packaging materials and /or circuits.
3. This product was designed and built strictly for the use indicated in this documentation. Any other use, not expressly indicated here, could compromise the good condition/operation of the product and/or be a source of danger. SEA S.p.A. declines all liability caused by improper use or different use in respect to the intended one.
4. The mechanical parts must be comply with Directives: Machine Regulation 2006/42/CE and following adjustments), Low Tension (2006/95/CE), electromgnetic Consistency (2004/108/CE) Installation must be done respecting Directives: EN12453 and En12445.
5. Do not install the equipment in an explosive atmosphere.
6. SEA S.p.A. is not responsible for failure to observe Good Techniques in the construction of the locking elements to motorize, or for any deformation that may occur during use.
7. Before attempting any job on the system, cut out electrical power and disconnect the batteries. Be sure that the earthing system is perfectly constructed, and connect it metal parts of the lock.
8. Use of the indicator-light is recommended for every system, as well as a warning sign well-fixed to the frame structure.
9. SEA S.p.A. declines all liability as concerns the automated system's security and efficiency, if components used, are not produced by SEAS.p.A..
10. For maintenance, strictly use original parts by SEA.
11. Do not modify in any way the components of the automated system.
12. The installer shall supply all information concerning system's manual functioning in case of emergency, and shall hand over to the user the warnings handbook supplied with the product.
13. Do not allow children or adults to stay near the product while it is operating. The application cannot be used by children, by people with reduced physical, mental or sensorial capacity, or by people without experience or necessary training. Keep remote controls or other pulse generators away from children, to prevent involuntary activation of the system.
14. Transit through the leaves is allowed only when the gate is fully open.
15. The User must not attempt to repair or to take direct action on the system and must solely contact qualified SEA personnel or SEA service centers. User can apply only the manual function of emergency.
16. The power cables maximum length between the central engine and motors should not be greater than 10 m. Use cables with 2,5 mm² section. Use double insulation cable (cable sheath) to the immediate vicinity of the terminals, in particular for the 230V cable. Keep an adequate distance (at least 2.5 mm in air), between the conductors in low voltage (230V) and the conductors in low voltage safety (SELV) or use an appropriate sheath that provides extra insulation having a thickness of 1 mm.

TERMS OF SALES

EFFICACY OF THE FOLLOWING TERMS OF SALE: the following general terms of sale shall be applied to all orders sent to SEA S.p.A. All sales made by SEA to all costumers are made under the prescription of this terms of sales which are integral part of sale contract and cancel and substitute all apposed clauses or specific negotiations present in order document received from the buyer.

GENERAL NOTICE The systems must be assembled exclusively with SEA components, unless specific agreements apply. Non-compliance with the applicable safety standards (European Standards EM12453 – EM 12445) and with good installation practice releases SEA from any responsibilities. SEA shall not be held responsible for any failure to execute a correct and safe installation under the above mentioned standards.

1) PROPOSED ORDER The proposed order shall be accepted only prior SEA approval of it. By signing the proposed order, the Buyer shall be bound to enter a purchase agreement, according to the specifications stated in the proposed order.

On the other hand, failure to notify the Buyer of said approval must not be construed as automatic acceptance on the part of SEA.

2) PERIOD OF THE OFFER The offer proposed by SEA or by its branch sales department shall be valid for 30 solar days, unless otherwise notified.

3) PRICING The prices in the proposed order are quoted from the Price List which is valid on the date the order was issued. The discounts granted by the branch sales department of SEA shall apply only prior to acceptance on the part of SEA. The prices are for merchandise delivered ex-works from the SEA establishment in Teramo, not including VAT and special packaging. SEA reserves the right to change at any time this price list, providing timely notice to the sales network. The special sales conditions with extra discount on quantity basis (Qx, Qx1, Qx2, Qx3 formula) is reserved to official distributors under SEA management written agreement.

4) PAYMENTS The accepted forms of payment are each time notified or approved by SEA. The interest rate on delay in payment shall be 1.5% every month but anyway shall not be higher than the max. interest rate legally permitted.

5) DELIVERY Delivery shall take place, approximately and not peremptorily, within 30 working days from the date of receipt of the order, unless otherwise notified. Transport of the goods sold shall be at Buyer's cost and risk. SEA shall not bear the costs of delivery giving the goods to the carrier, as chosen either by SEA or by the Buyer. Any loss and/or damage of the goods during transport, are at Buyer's cost.

6) COMPLAINTS Any complaints and/or claims shall be sent to SEA within 8 solar days from receipt of the goods, proved by adequate supporting documents as to their truthfulness.

7) SUPPLY The concerning order will be accepted by SEA without any engagement and subordinately to the possibility to get it's supplies of raw material which is necessary for the production; Eventual completely or partially unsuccessful executions cannot be reason for complains or reservations for damage. SEA supply is strictly limited to the goods of its manufacturing, not including assembly, installation and testing. SEA, therefore, disclaims any responsibility for damage deriving, also to third parties, from non-compliance of safety standards and good practice during installation and use of the purchased products.

8) WARRANTY The standard warranty period is 12 months. This warranty time can be extended by means of expedition of the warranty coupon as follows:

SILVER: The mechanical components of the operators belonging to this line are guaranteed for 24 months from the date of manufacturing written on the operator.

GOLD: The mechanical components of the operators belonging to this line are guaranteed for 36 months from the date of manufacturing written on the operator.

PLATINUM: The mechanical components of the operators belonging to this line are guaranteed for 36 months from the date of manufacturing written on the operator. The base warranty (36 months) will be extended for further 24 months (up to a total of 60 months) when it is acquired the certificate of warranty which will be filled in and sent to SEA S.p.A. The electronic devices and the systems of command are guaranteed for 24 months from the date of manufacturing. In case of defective product, SEA undertakes to replace free of charge or to repair the goods provided that they are returned to SEA repair centre. The definition of warranty status is by unquestionable assessment of SEA. The replaced parts shall remain propriety of SEA. Binding upon the parties, the material held in warranty by the Buyer, must be sent back to SEA repair centre with fees prepaid, and shall be dispatched by SEA with carriage forward. The warranty shall not cover any required labour activities.

The recognized defects, whatever their nature, shall not produce any responsibility and/or damage claim on the part of the Buyer against SEA. The guarantee is in no case recognized if changes are made to the goods, or in the case of improper use, or in the case of tampering or improper assembly, or if the label affixed by the manufacturer has been removed including the SEA registered trademark No. 804888. Furthermore, the warranty shall not apply if SEA products are partly or completely coupled with non-original mechanical and/or electronic components, and in particular, without a specific relevant authorization, and if the Buyer is not making regular payments. The warranty shall not cover damage caused by transport, expendable material, faults due to non-conformity with performance specifications of the products shown in the price list. No indemnification is granted during repairing and/or replacing of the goods in warranty. SEA disclaims any responsibility for damage to objects and persons deriving from non-compliance with safety standards, installation instructions or use of sold goods. The repair of products under warranty and out of warranty is subject to compliance with the procedures notified by SEA.

9) RESERVED DOMAIN A clause of reserved domain applies to the sold goods; SEA shall decide autonomously whether to make use of it or not, whereby the Buyer purchases propriety of the goods only after full payment of the latter.

10) COMPETENT COURT OF LAW In case of disputes arising from the application of the agreement, the competent court of law is the tribunal of Teramo. SEA reserves the faculty to make technical changes to improve its own products, which are not in this price list at any moment and without notice. SEA declines any responsibility due to possible mistakes contained inside the present price list caused by printing and/or copying. The present price list cancels and substitutes the previous ones. The Buyer, according to the law No. 196/2003 (privacy code) consents to put his personal data, deriving from the present contract, in SEA archives and electronic files, and he also gives his consent to their treatment for commercial and administrative purposes.

Industrial ownership rights: once the Buyer has recognized that SEA has the exclusive legal ownership of the registered SEA brand num.804888 affixed on product labels and / or on manuals and / or on any other documentation, he will commit himself to use it in a way which does not reduce the value of these rights, he won't also remove, replace or modify brands or any other particularity from the products. Any kind of replication or use of SEA brand is forbidden as well as of any particularity on the products, unless preventive and expressed authorization by SEA.

In accomplishment with art. 1341 of the Italian Civil Law it will be approved expressly clauses under numbers:

4) PAYMENTS - 8) GUARANTEE - 10) COMPETENT COURT OF LAW



SEA[®]
electronic opening system

Questo articolo è stato prodotto seguendo rigide procedure di lavorazione ed è stato testato singolarmente al fine di garantire i più alti livelli qualitativi e la vostra soddisfazione. Vi ringraziamo per aver scelto SEA.

This item has been produced following strict production procedures and has been singularly tested for the highest quality levels and for your complete satisfaction.
Thanks for choosing SEA.

Cet article a été produit suivant des procédures d'usinage strictes et il a singulièrement été testé afin de garantir les plus hauts niveaux de qualité pour votre satisfaction.
Nous vous remercions d'avoir choisi SEA.

Este artículo ha sido producido siguiendo rigidos procedimientos de elaboracion y ha sido probando singolarmente a fin de garantizar los mas altos niveles de calidad y vuestra satisfaccion.
Le agradecemos por haber escogito SEA.



SEA®
Sistemi Elettronici
di Apertura Porte e Cancelli
International registered trademark n. 804888



Dichiarazione di conformità
Declaration of Conformity

La SEA S.p.A. dichiara sotto la propria responsabilità e, se applicabile, del suo rappresentante autorizzato che il prodotto:

SEA S.p.A. declares under its proper responsibility and, if applicable, under the responsibility of its authorised representative that the product:

Descrizione / Description	Modello / Model	Marca / Trademark
Full Tank 270 AC (e tutti i suoi derivati)	10601005	SEA
<i>Full Tank 270 AC (and all its by-products)</i>	<i>10601005</i>	<i>SEA</i>
Full Tank 390 AC (e tutti i suoi derivati)	10701010	SEA
<i>Full Tank 390 AC (and all its by-products)</i>	<i>10701010</i>	<i>SEA</i>

è costruito per essere incorporato in una macchina o per essere assemblato con altri macchinari per costruire una macchina ai sensi della Direttiva 2006/42/CE:

is built to be integrated into a machine or to be assembled with other machinery to create a machine under the provisions of Directive 2006/42/CE:

è conforme ai requisiti essenziali di sicurezza relativi al prodotto entro il campo di applicabilità delle Direttive Comunitarie 2006/95/CE e 2004/108/CE.

it is conforming to the essential safety requirements related to the product within the field of applicability of the Community Directives 2006/95/CE and 2004/108/CE.

COSTRUTTORE o RAPPRESENTANTE AUTORIZZATO:
MANUFACTURER or AUTHORISED REPRESENTATIVE:

SEAS.p.A.
DIREZIONE E STABILIMENTO:
Zona industriale 64020 S.ATTO Teramo - (ITALY)
Tel. 0861 588341 r.a. Fax 0861 588344
[Http://www.seateam.com](http://www.seateam.com)

I test sul prodotto sono stati effettuati in configurazione standard e in riferimento alle norme specifiche per la sua classe d'utilizzo.

The products have been tested in standard configuration and with reference to the special norms concerning the classe of use.

(Luogo, data di emissione)
(Place, date of issue)
Teramo, 05/11/2013

L'Amministratore
The Administrator
Ennio Di Saverio

CERTIFICATO DI ESTENSIONE GARANZIA CERTIFICATE OF WARRANTY EXTENTION

n.

PRODOTTO/ PRODUCT

- Modello/*Model* _____
- Matricola n. /*Serial Number* _____
- Data di acquisto/*Date of order* _____
- Data di installazione/*Date of installation* _____

Centrale/Control unit

SEA ☐

Altri/Others

☐

Fotocellule/Photocells

SEA ☐

Altri/Others

☐

RX - TX

SEA ☐

Altri/Others

☐

Altri accessori /Other accessories

SEA ☐

Altri/Others

☐

UTENTE/Customer

Nome e Cognome _____

First Name and Family Name _____

Indirizzo/Address _____

INSTALLATORE/Installer

Ragione sociale/*Company Name* _____

Nome e Cognome/*First and Family Name* _____

Indirizzo/Address _____

INSTALLATORE/INSTALLER

Firma per il trattamento dei dati personali 196/2003

Agreement of law No. 196/2003 (Privacy Code)

Copia da restituire
Copy to be returned

Firma e Timbro

Sign and Stamp _____

N.B: L'estensione della garanzia legale di 12 mesi a 24 mesi e 36 mesi è valida solo se il presente modulo viene rispedito per posta o fax a SEA S.p.A. entro 15gg dalla data di acquisto. Allegare relativa fattura d'acquisto.

Note: The extension of the legal standard warranty of 12 months to 24 months and to 36 months, is valid only if the present form is returned by mail or fax to SEA S.p.A within 15days from the date of purchase. Attach customer invoice.



SEA®
Sistemi Elettronici
di Apertura Porte e Cancelli
International registered trademark n. 804888

SEA S.p.A. - Zona Industriale San Atto- 64020 Teramo (Italy)

Phone +39 0861 588341- Fax +39 0861588344

www.seateam.com - info@seateam.com

[illegible]

[illegible]

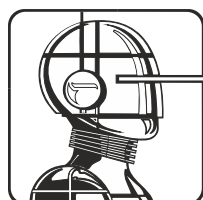

SEA®

Sistemi Elettronici
di Apertura Porte e Cancelli
International registered trademark n. 804888



SEA S.p.A.
Zona industriale 64020 S.ATTO Teramo - (ITALY)
Tel. +39 0861 588341 r.a. Fax +39 0861 588344

www.seateam.com

seacom@seateam.com