



S.E.A (UK) Limited,
Unit 6A Olton Wharf (off Richmond Road)
Olton, Solihull.
B92 7RN
Tele: 0121 706 9629, Fax: 0121 764 5603
Email: SALES@SEAUKLTD.CO.UK
www.seaukltd.co.uk



PHOTO GHOST 40 INFRARED BEAM

INSTALLATION & MAINTENANCE MANUAL FOR INFRARED BEAM PHOTOCELL GHOST 40 (23102070)

General

The 23102070 photocell has been designed to be compact and to provide speed of installation, operation and durability. Unit size: (57x85x33 mm).
The high resistance acrylic plastic provides classic styling plus the strength required to stand the test of time.

The 23102070 Photocell Kit consists of:

- No. 1 23102070 Photocell Receiver
- No. 1 23102070 Photocell Transmitter
- No. 1 Fixing Kit
- No. 2 Cover-screw cap
- No. 1 Set of fitting instructions.

Technical Characteristics

Range:	15 m. (exterior use)
Signal:	Modulated infrared
Wave Length:	880nm
Modulation Frequency:	1000Hz
Supply Voltage:	12 - 24 Vac/Vdc
Absorbed Current:	Tx:30 mA - Rx:30 mA
Temperature Operating Range:	-15°C/ +60°C
Relay Contact Rating:	1A max @24v
Humidity:	from 5% to 90% no condensation

INSTALLATION

Transmitter

- Feed the cable in through the back of the unit and make connections as show in fig.2.
- Adjust the cable within the unit to eliminate any surplus
- Fix the unit as shown in fig.3.
- Seal the cover & cable entry to prevent insect infestation.

Receiver

- Feed the cable in through the back of the unit and make connections as shown in fig.2.
- Adjust the cable within the unit to eliminate any surplus.
- Fix the unit as shown in fig.3.
- Take care in positioning, verify the alignment and height will be same as that of the transmitter.
- Seal the cover & cable entry to prevent insect infestation.

Operational set-up and testing:

- Power-up the photocells (12 - 24 volts ac/dc).

Please Note: The correct working of the 23102070 photocell is indicated by the red led being lit.

Operational Verification

Fit one of the black plastic photocell covers complete with an opaque diffuser label stuck across the lens.

- Check the relay works correctly
- Check that the red led goes out when the beam is broken

Red led Function

RED LED LIT: 23102070 CORRECTLY ALIGNED. NORMAL QUIESCENT STATE.

RED LED UNLIT: 23102070 INCORRECTLY ALIGNED OR BEAM INTERRUPTED

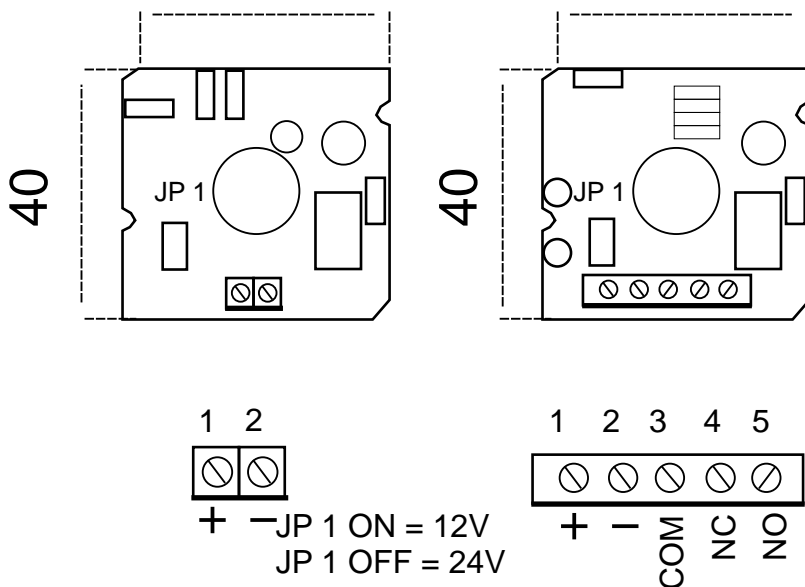

FIG 2

**SEA**

S.E.A (UK) Limited,
 Unit 6A Olton Wharf (off Richmond Road)
 Olton, Solihull.
 B92 7RN
 Tele: 0121 706 9629, Fax: 0121 764 5603
 Email: SALES@SEAUKLTD.CO.UK
 www.seaukltd.co.uk



PHOTO GHOST 40

INFRARED BEAM

INSTALLATION & MAINTENANCE MANUAL FOR INFRARED BEAM PHOTOCELL GHOST 40 (23102070)

SECURITY

The 23102070 device cannot be used as security device (EN 12978).

SPARE PARTS

To obtain spare parts contact:
SEA(UK)LTD

INTENDED USE

The 23102070 Photocell is specifically designed for use in the automatic gate industry to provide automatic gates or traffic barriers with hold open safe.

ENVIRONMENT

Please dispose of this product packaging in a responsible, appropriate way.

CONFORMITIES

The 23102070 Photocell conforms to the following:
 - 89/336/CEE (Act on the Electromagnetic Compatibility).

STORAGE

when being transported this product must be properly packaged and handled with care.

CLEANING AND MAINTENANCE

Cleaning and maintenance of this unit must be carried out two times a year by authorised, qualified checks should be made: correct alignment, sealing, cleaning of the lenses and internal components. Any remedial work should be carried out as required.

DECOMMISSIONING

If the 23102070 Photocell is to be taken out of service, this work must only be undertaken by authorised, qualified personnel.

LIMIT OF GUARANTEE

The 23102070 Photocell is guaranteed for a period of 24 months. The guarantee period starts from the date stamp printed on the product. The guarantee will be void if the photocells have been incorrectly installed, not used for the purpose intended, tampered with or modified in any way.

The validity of this guarantee only extends to the original purchaser.

N.B. THE MANUFACTURER CAN NOT BE DEEMED RESPONSIBLE FOR ANY DAMAGE OR INJURY CAUSED BY IMPROPER USE OF THIS PRODUCT.

STOCKING TEMPERATURES	
T min	T max
-20°C	+70°C
Humidity min	Humidity max
5% no condensation	90% no condensation

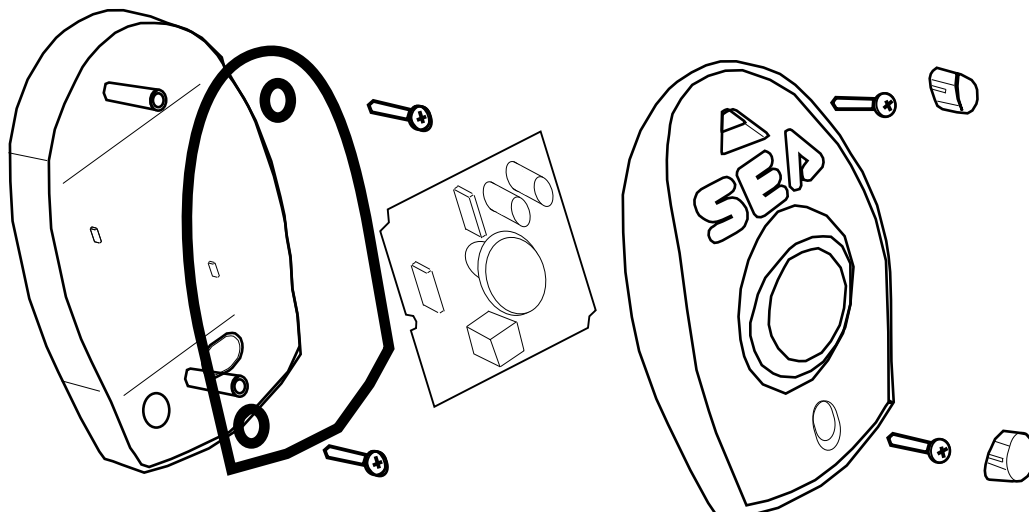

FIG 3.